

TOWNSHIP 16 NORTH RANGE 28 WEST.

Scale 2 Inches to the Mile.

of the 5th Principal Meridian.

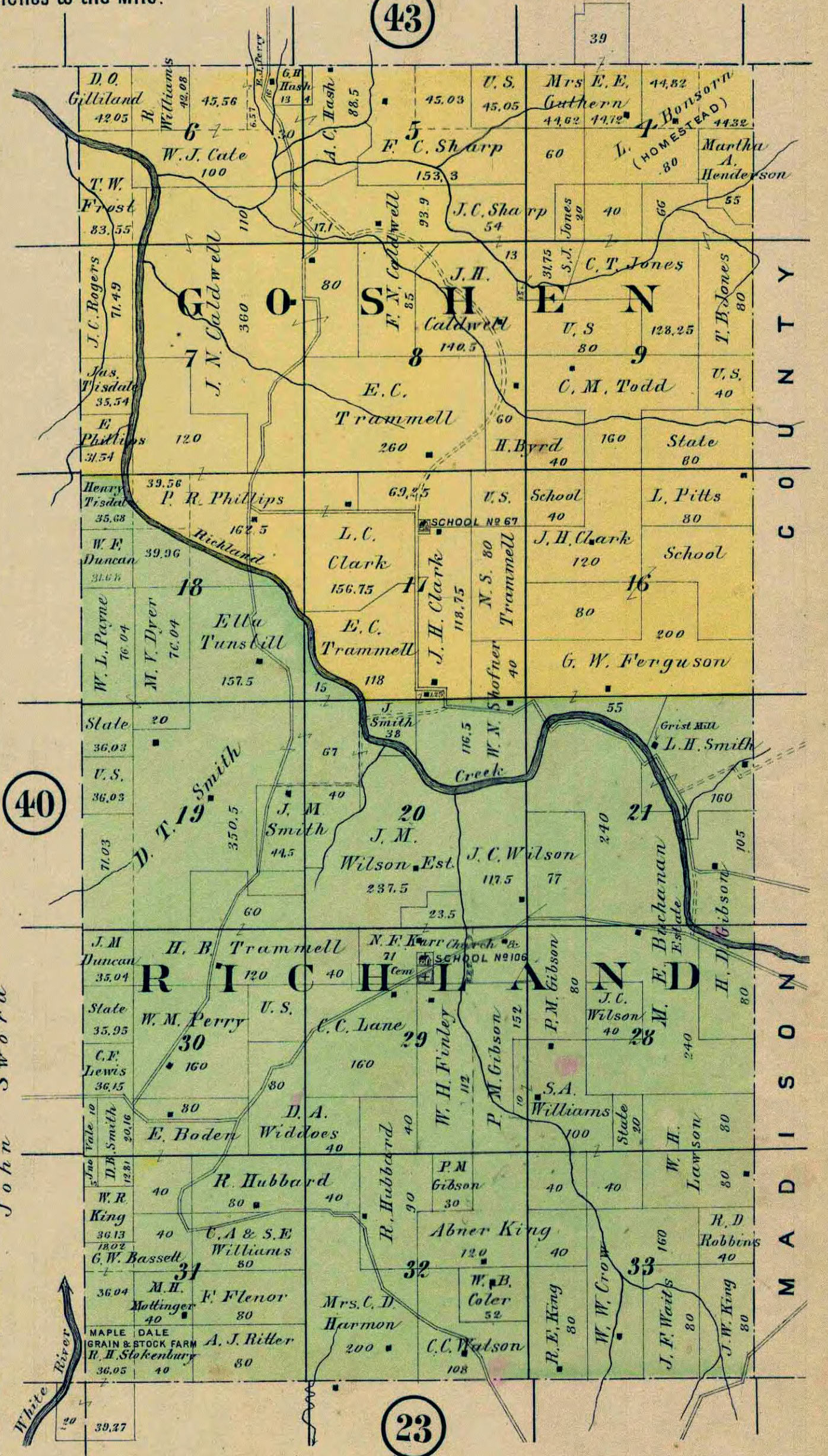

CORRECTED PLAT OF
HARRIS
 ON SECTION 27-16-29
 Scale 200 feet to 1 inch.

W. A. M. Harris

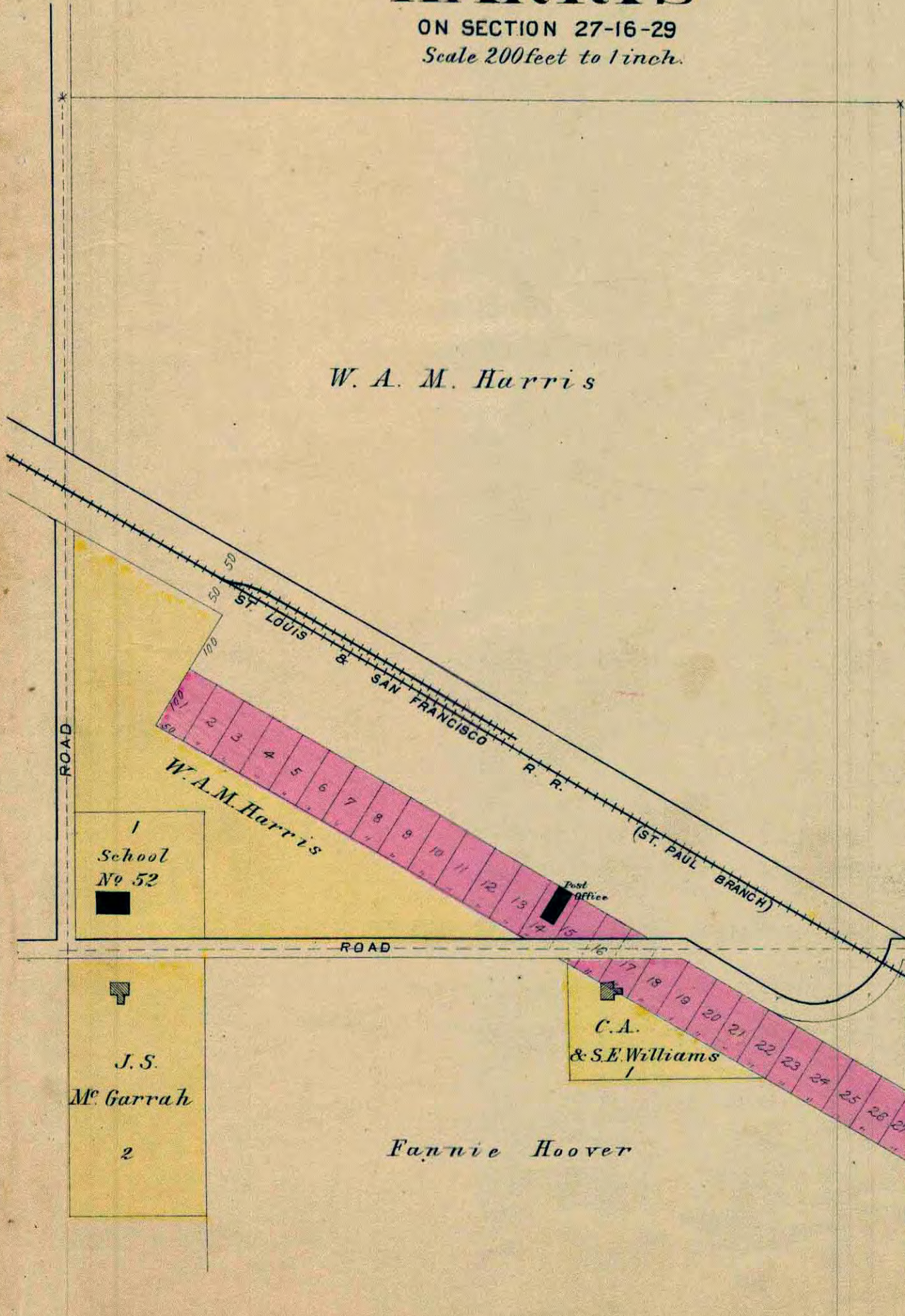

John Sword

E.B. Clark